

OXFORD STREET

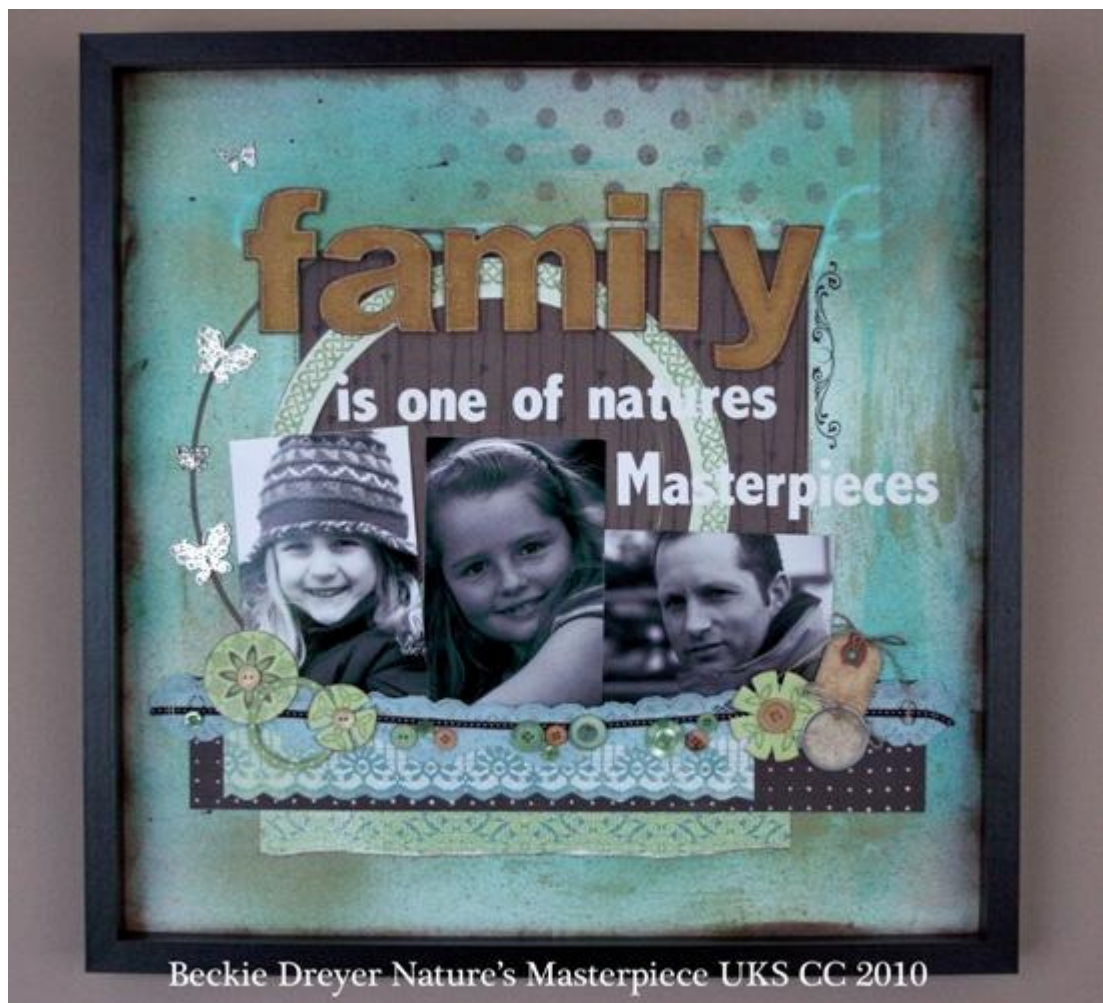

DESIGNER: Beckie Dreyer

An oversized layout, perfect for hanging on the wall!



TIME NEEDED TO COMPLETE CLASS: approx 2 hours

***PROFIT ON COMPLETION: £300 for using GLIMMER MISTS (or similar)
£100 for NOT using Glimmer Mists***



OXFORD STREET

Supplies Needed:

· 1 x Wool/String · 1 x Ikea Ribba 50 x 50 x 4.5cm Frame · 1 x Old/Cheap Necklace with butterfly charms · 1 x Rusty Pickle 12 x 12 Corrugated ABC/ or cut outs from template in corrugated card · 1 x Rusty Pickle Lucky Trim · 8 x Various Sized Pale Green Buttons · 6 x Various Sized Fawn Buttons · 1 x Rusty Pickle Small Distressed Luggage Tag · 1 x Rusty Pickle Small Distressed Round Tag · 1 x Rusty Pickle Lucky The Emerald Rose · 1 x Rusty Pickle Lucky Nine Fine Irishmen · 1 x Rusty Pickle Lucky Anna Caughlin's · 1 x Rusty Pickle Lucky Fitzpatricks · 1 x Rusty Pickle Chocolate Kisses Ganache · 1 x Rusty Pickle Chocolate Kisses Special Dark · 1 x Rusty Pickle Rocking America Alphabet Stickers – White · 1 x Colorbox Fluid Chalk Ink Pad – Chestnut Roan · Glimmer Mist – Gold, Turquoise Blue, Olive Vine, Blue Skies, Crème De Chocolat · 1 x Heidi Swapp Polka Dot Mask or punch circles in a piece of card stock · 1 x Swirled Rub on

Tools include · 1 x Stapler · 1 x Black Pen · 1 x White Pen · Old Newspaper to cover the table!!

Photo 3 x 6" x 4"

Instructions:

Before you begin Cover the area you are going to create in with newspaper!! Glimmer Mist will cover everything in sight even if you are being careful!!

1. Remove the mount from the ribba frame and place on the newspaper. (I have added some white paper in the centre of mine just to hide the newspaper article.) Hold the Blue Skies glimmer mist bottle about 12" from the frame and spray covering the frame.

2. Hold the Turquoise Blue glimmer mist about 6" from the mount and spray in a few places around the frame.

3. Move your hand through the glimmer mist you have just sprayed to smooth it around the frame.



OXFORD STREET

4. Place your polka dot mask along the edge of one part of the frame. Spray the whole mount with Crème De Chocolat glimmer mist, holding the bottle about 12" away.

5. Take a good length of wool/string and lay around the central cut out of the mount to create a frame in a pattern you desire.

6. Spray with Olive Vine glimmer mist, don't worry if the wool/string moves it will look fine. Gently remove the wool/string to reveal the border of the frame. The glimmer mists look quite strong at this point but they will mellow!

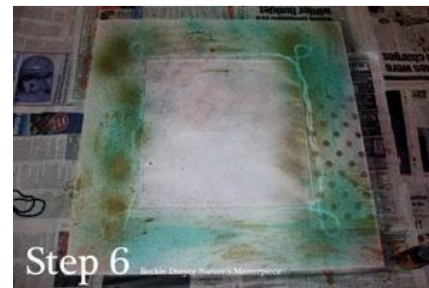

7. Choose which way you would like your mount, I have placed the polka dots at the top on this layout. Adhere the Special Dark paper to the back of mount dark side facing through the middle.

8. Take the Emerald Rose paper and using a craft knife cut out the outer brown circle and the large white circle with the celtic knot in.

9. Rip approximately 6" off the Fitzpatrick's paper, ink the ripped edge. Adhere to the bottom left of the mount. Adhere the brown circle and white circle to the left side of the central cut out of the mount as shown in the picture.

10. Cut a 12" x 3" strip and a 5" x 3" from the Ganache paper. Adhere along the bottom of the central cut out of the mount, using both pieces to create a one long piece.

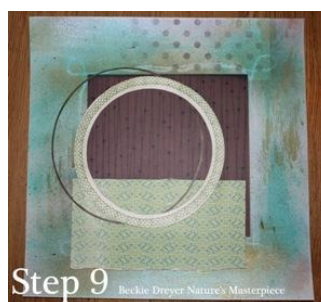
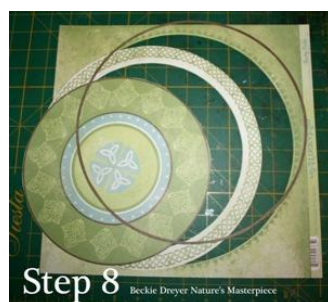

OXFORD STREET

11. Cut the blue lacy strip from the Anna Caughlin's paper and adhere through the Ganache paper on the left handside.
12. Adhere your three photos along the top edge of the Ganache paper. Secure a strip of blue and brown ribbon along the bottom edge of the photos with staples.
13. Cut out some shapes from the Nine Fine Irishmen paper and adhere to the bottom corners of the layout on the ribbon along with the tags.



14. Spray the letters 'family' with Gold glimmer mist and when dry ink the edges. Adhere to the top of the central cut out of the mount. Use the white alphabet stickers to write 'is one of nature's masterpieces'.
15. Adhere buttons along the ribbon and in the patterned circles, alternating the colours. Adhere some butterflies to the left side using the thin brown circle as a guide.
16. Ink the edges of the mount and outline the word 'family' in white pen. Use the rub on along the right side of the central cut out.
17. Put your creation back into the frame and place on the wall!

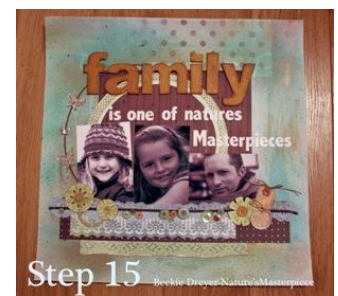
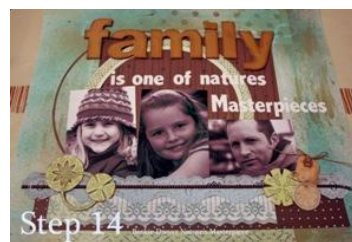

OXFORD STREET

Word Template

